

PARTS LIST

**Attachment Kit
P/N 08V03-SZT-100C**

Automatic day/night mirror harness

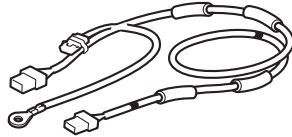

EPT sealer

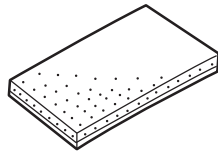

Clip



5 Wire ties

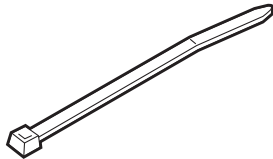

Fuse label

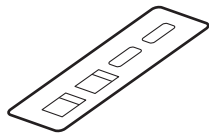

Harness cover

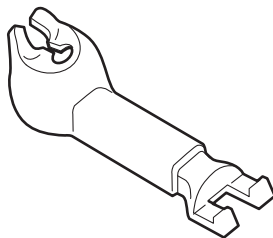

Ground bolt

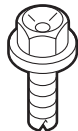

Automatic Day/Night Mirror Kit P/N 08V03-TA0-100A

Automatic day/night mirror

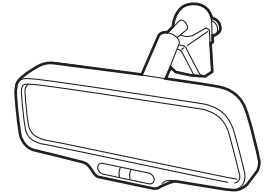

Spring



Operating Instructions

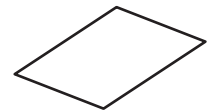

TOOLS AND SUPPLIES REQUIRED

Phillips screwdriver

Ratchet

8 mm and 10 mm Sockets

Isopropyl alcohol

Shop towel

Diagonal cutters

Needle nose pliers

10 mm Open end wrench

Rubber mallet

Flat-tip screwdriver

Masking tape

Flashlight

The following tool is available through the Honda Tool and Equipment Program. On the iN, click on Service > Service Bay > Tool and Equipment Program, then enter the number under "Search." Or, call 888-424-6857.

- Plastic Trim Tool (T/N SILTRIMTL10)

Illustration of the Automatic Day/Night Mirror in the Vehicle

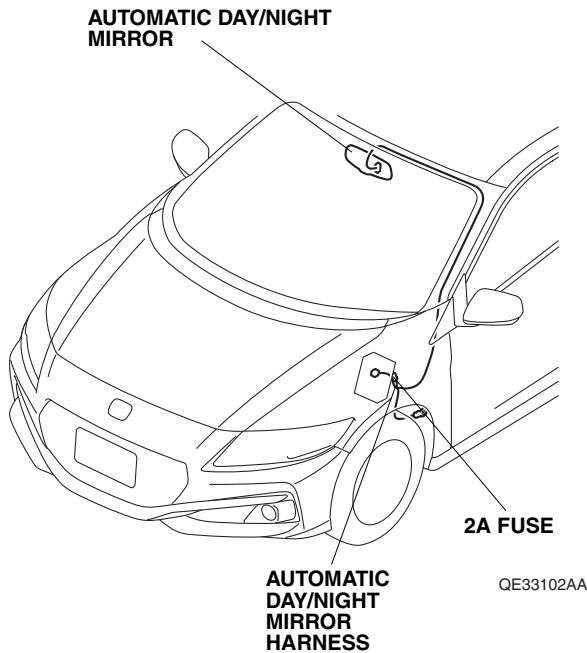

INSTALLATION

Customer Information: The information in this installation instruction is intended for use only by skilled technicians who have the proper tools, equipment, and training to correctly and safely add equipment to your vehicle. These procedures should not be attempted by "do-it-yourselfers."

1. Disconnect the negative cable from the battery.

2. Using a plastic trim tool, remove the left and right lens from the map light console.

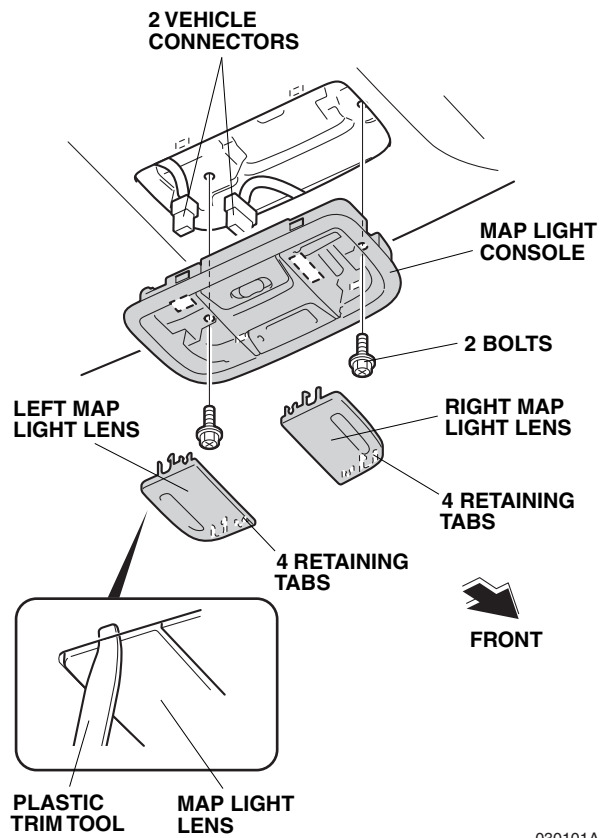

030101A

3. Remove the map light console.
4. Remove the rearview mirror from the mirror holder by rotating the stay 90° clockwise.

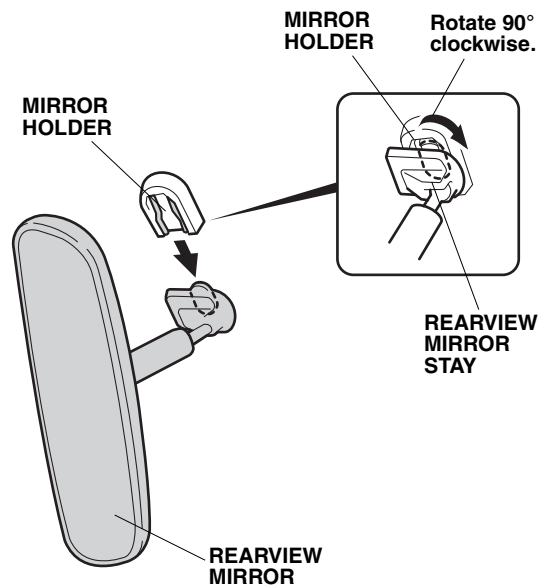

872105B

- Turn the left sunvisor toward the driver's seat.

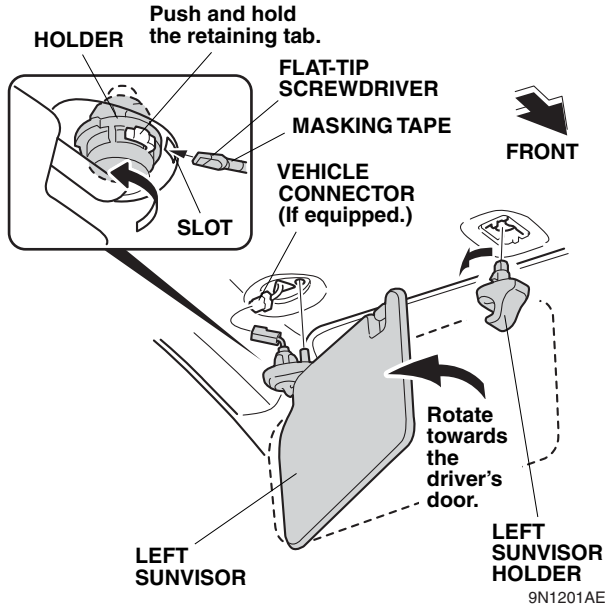

- Turn and remove the left sunvisor holder.
- Locate the slot in the holder, and insert a flat-tip screwdriver wrapped with a masking tape into the slot. Push and hold the retaining tab.
- While holding the retaining tab, push up on the left sunvisor and rotate towards the door to release the left sunvisor and remove the left sunvisor.
NOTE: If the retaining tab did not stay pushed in, return the left sunvisor to its original position and repeat steps 7 and 8.

- Pull away the door seal from around the driver's A-pillar trim.

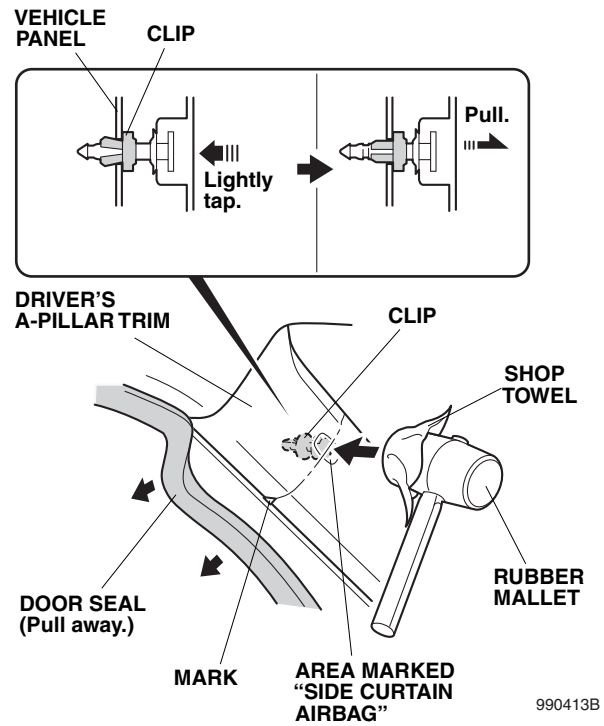

- Using a rubber mallet wrapped with a shop towel, lightly tap the area marked "SIDE CURTAIN AIRBAG" on the top of the driver's A-pillar trim to push in the clip. Make sure to strike area perpendicular to the A-pillar surface.
- Remove the driver's A-pillar trim.

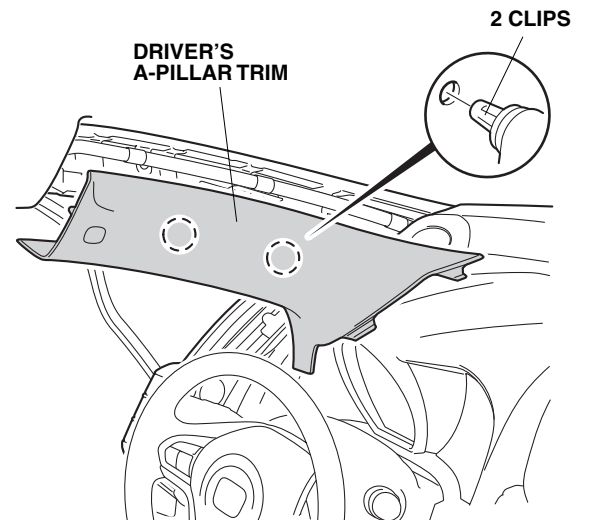

030103A

12. Remove the fuse lid.

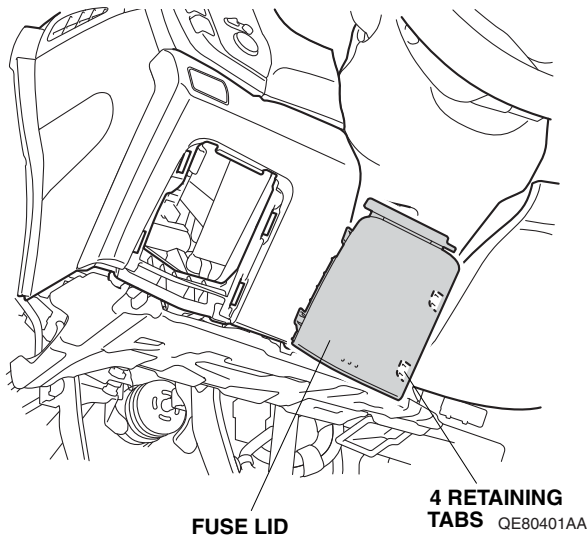

13. Remove the driver's under cover (turn the knob, two clips and one pin).

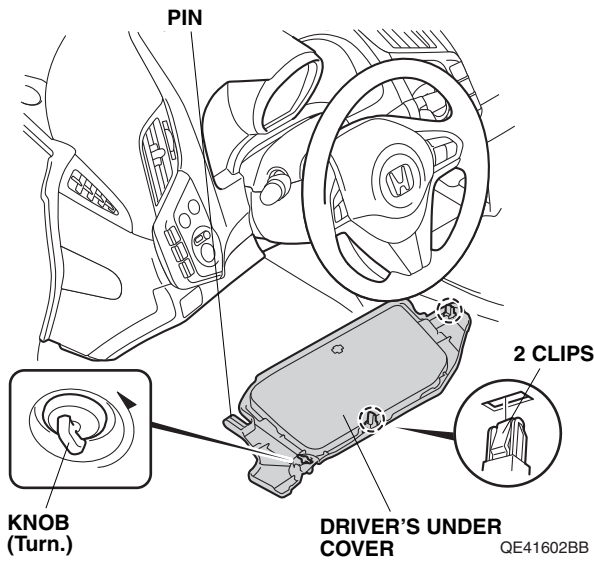

14. Pull away the door seal from the driver's kick panel. Remove the driver's kick panel (two clips and three retaining tabs).

NOTE: If the vehicle is equipped with the foot lights, unplug the vehicle connector.

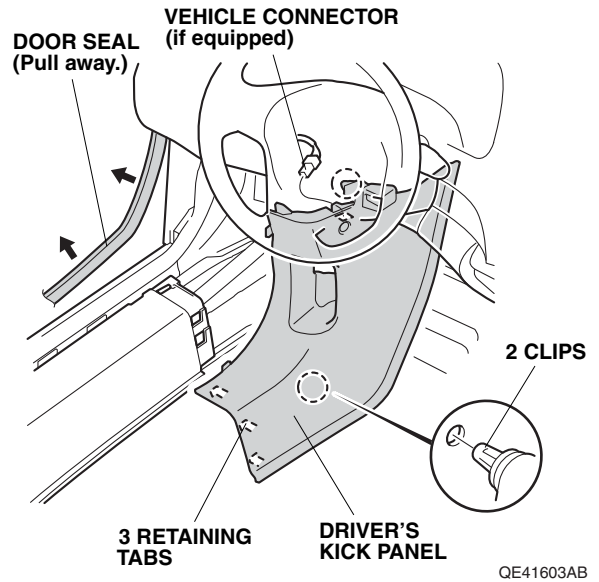

- Using a needle nose pliers, remove the vehicle spring and install the new spring into the mirror holder.

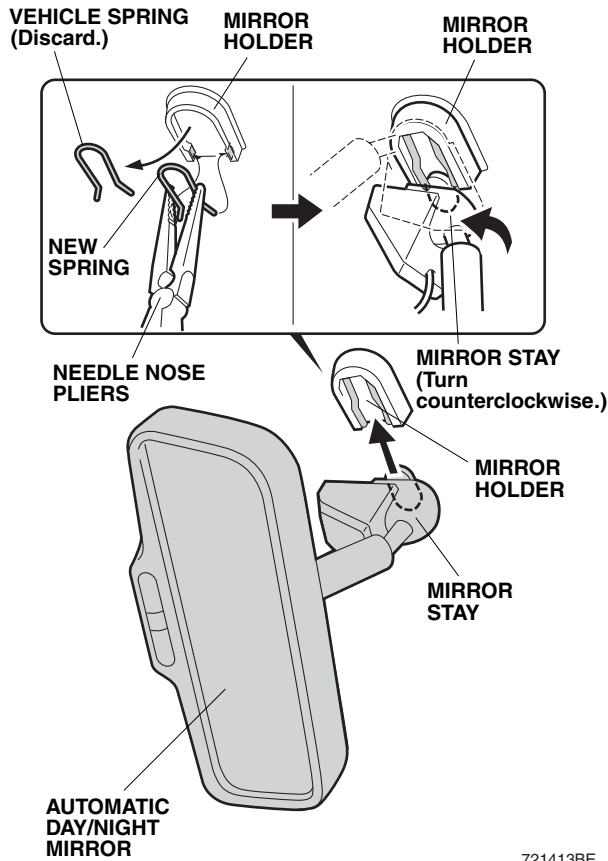

- Slide the automatic day/night mirror stay into the mirror holder. Then turn the mirror stay counterclockwise to secure the automatic day/night mirror in the holder.

- Using isopropyl alcohol on a shop towel, thoroughly clean the fuse case where the fuse label will attach.

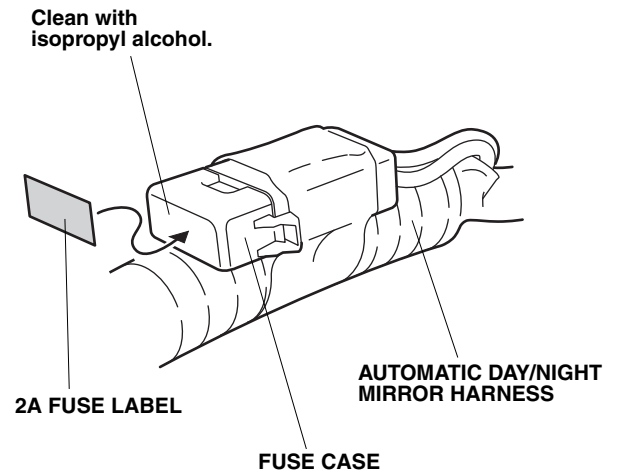

- Attach the 2A fuse label to the fuse case on the automatic day/night mirror harness.

If the vehicle is equipped with other accessory harness 8-pin connector, continue with step 19; otherwise, go to step 20.

With other accessory harness 8-pin connector

- Remove the dummy connector from the other accessory harness 8-pin connector. Plug the automatic day/night mirror harness 8-pin connector into the other accessory harness 8-pin connector. Go to step 21.

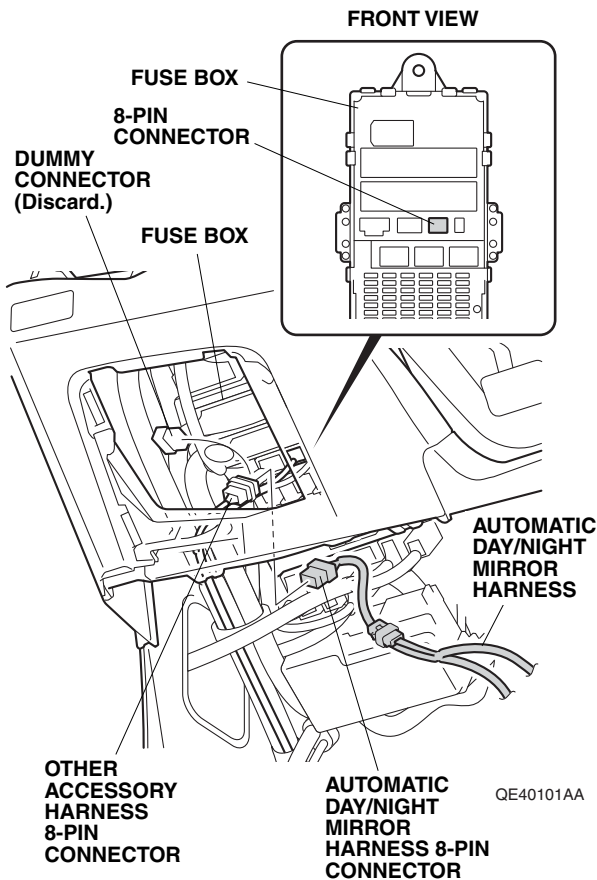

Without other accessory harness 8-pin connector

- Plug the automatic day/night mirror harness 8-pin connector into the fuse box 8-pin connector.

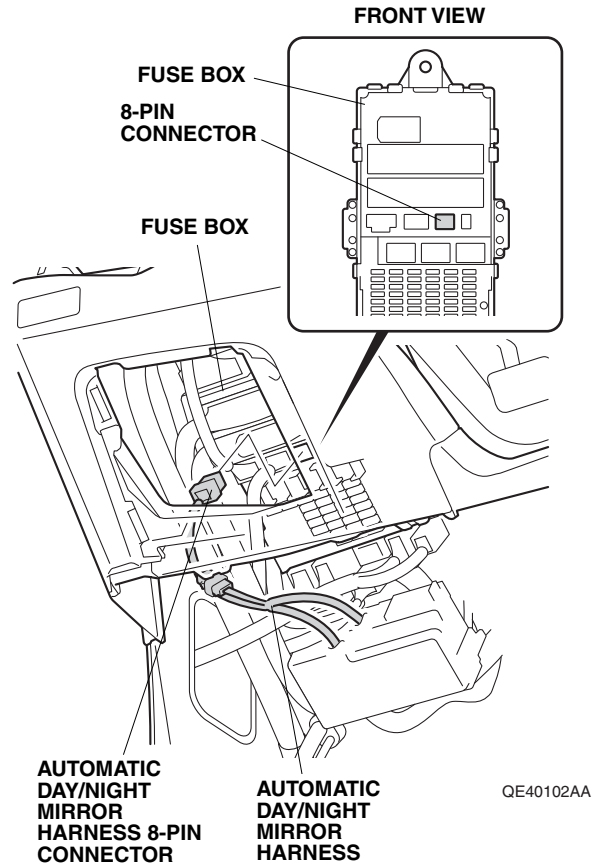

- Route the automatic day/night mirror harness ground terminal toward the hood opener.

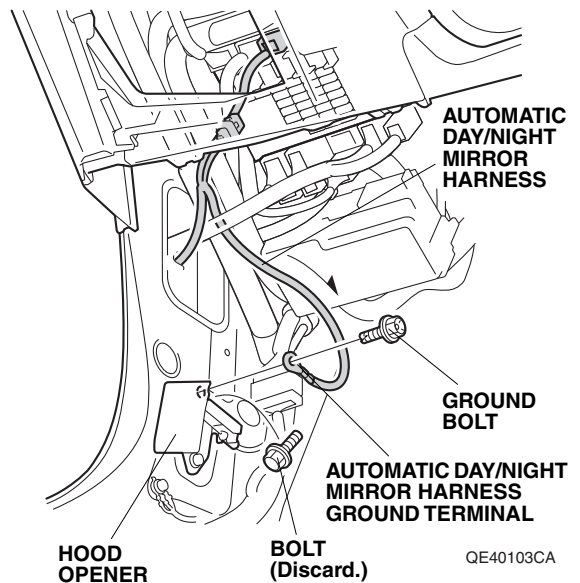

- Remove the bolt. Secure the automatic day/night mirror harness ground terminal to the hood opener with the ground bolt.

23. Secure the automatic day/night mirror harness to the vehicle harness with two wire ties.

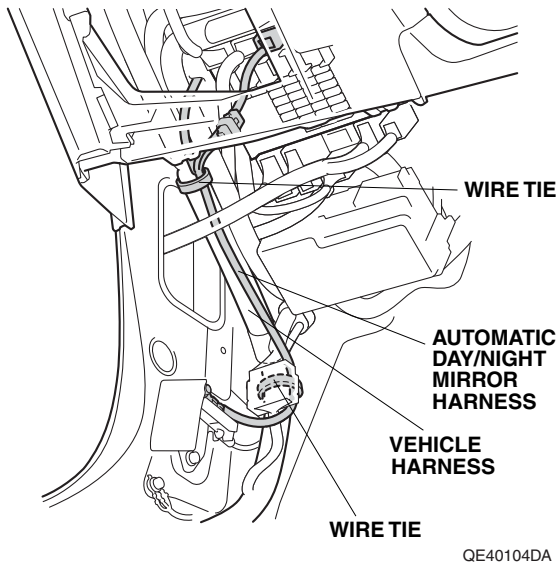

24. Pull away the door seal from around the dashboard.

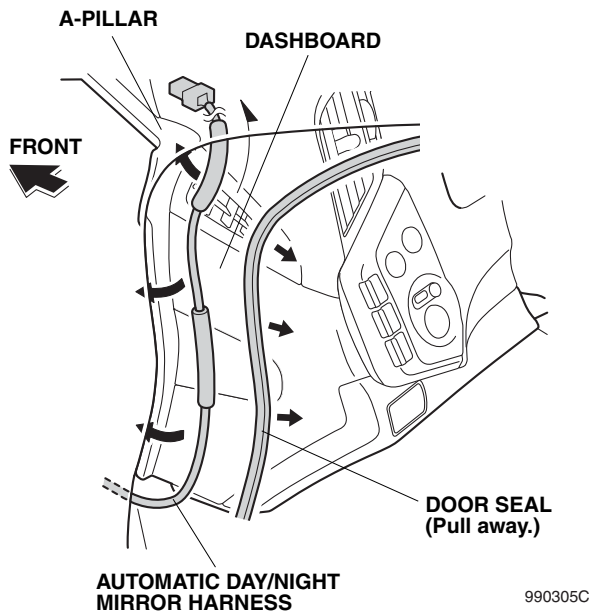

25. Insert the automatic day/night mirror harness between the dashboard and the A-pillar.

26. Align the green tape on the automatic day/night mirror harness with the vehicle clip, and secure the automatic day/night mirror harness to the vehicle harness with three wire ties.

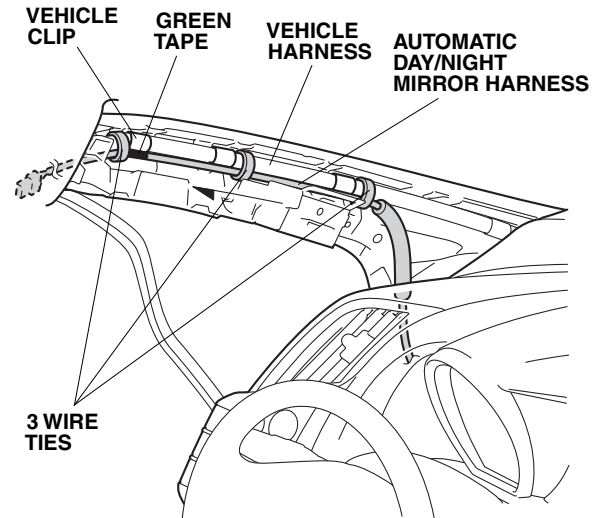

27. Route the automatic day/night mirror harness under the headliner as shown. Be careful not to crease the headliner.

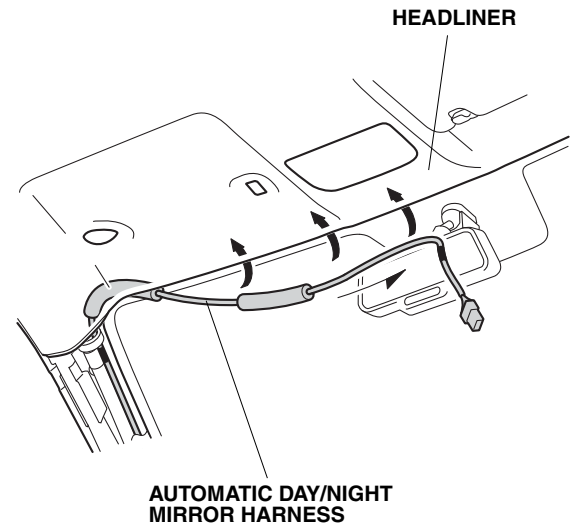

28. Plug the automatic day/night mirror harness 7-pin connector to the automatic day/night mirror.

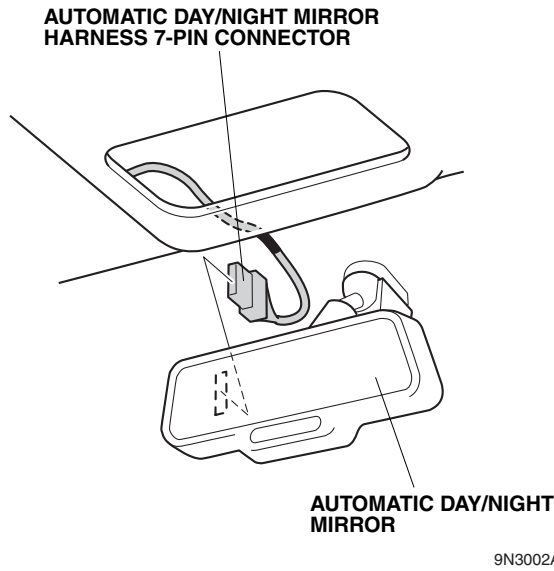

29. Align the green tape on the automatic day/night mirror harness at the headliner. Route the automatic day/night mirror harness through the grooves on the harness cover. Secure the harness cover to the mirror stay.

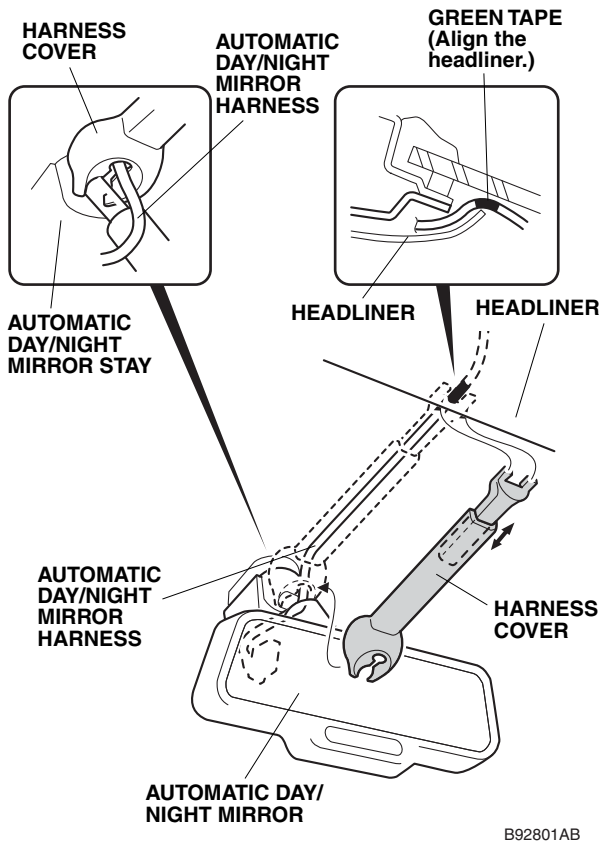

30. Slide the upper end of the harness cover behind the headliner.
31. Using isopropyl alcohol on a shop towel, thoroughly clean the vehicle panel where the EPT sealer will attach. Secure the automatic day/night mirror harness to the vehicle panel with one EPT sealer as shown.

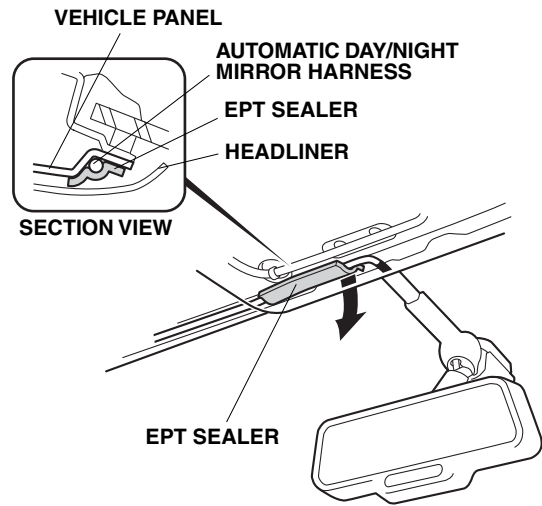

32. Remove and discard the vehicle clip from the driver's A-pillar trim and install the new clip.

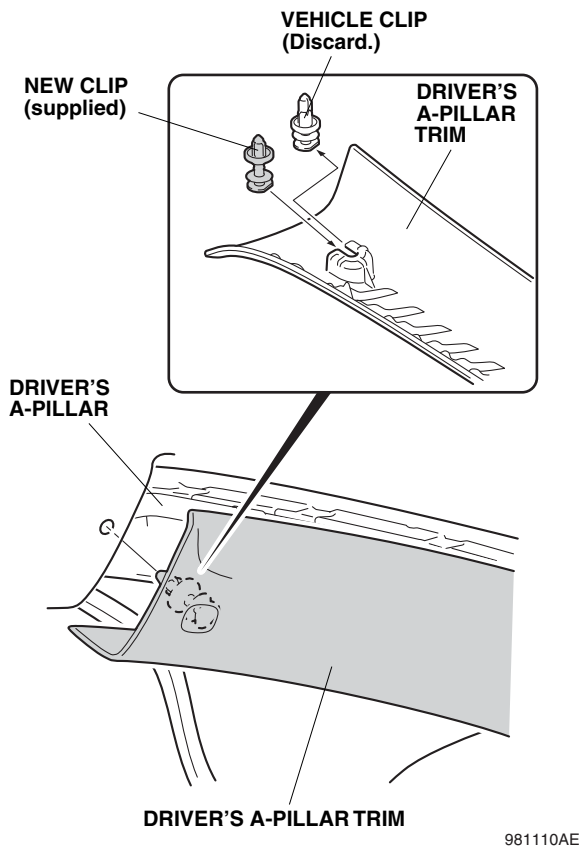

981110AE

33. Reinstall the driver's A-pillar trim.
34. Check that all wire harnesses are routed properly and all connectors are plugged in.
35. Install all removed parts.
36. Connect the negative cable to the battery.
37. Press and hold the audio unit power button for 2 seconds to restore the audio and navi (if equipped) system functions.
38. Reset the clock (on vehicles without navigation).
39. If the IMA battery charge level indicator is at zero, start the engine, and hold it between 3,500 and 4,000 rpm (without load) in Park or Neutral until the IMA battery charge level indicator is at least half charged.
- NOTE:
- Check the operation of the automatic day/night mirror according to the Operating Instructions supplied.
 - Adjust the zone and calibrate as required.
40. Put the Operating Instructions in the glove box.

Check the Operation of the Automatic Day/Night Mirror

1. Press the engine switch to ON, but do not start the engine.
2. Turn on the switch. Check that the LED lights.

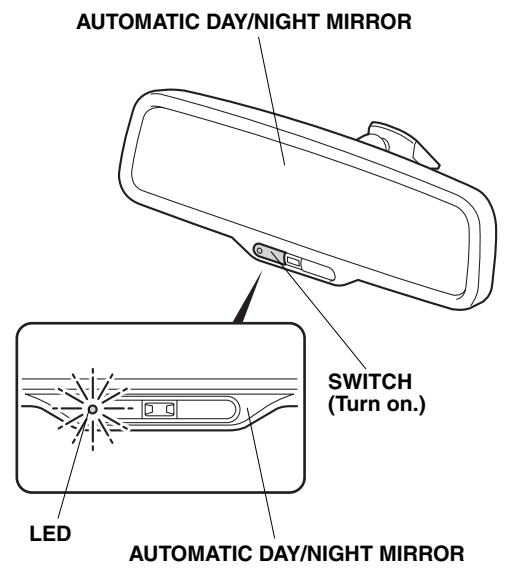

030406AB

3. Cover the front sensor on the automatic day/night mirror with your hand, and use a flashlight to light the rear sensor on the automatic day/night mirror. Make sure the mirror surface dims.

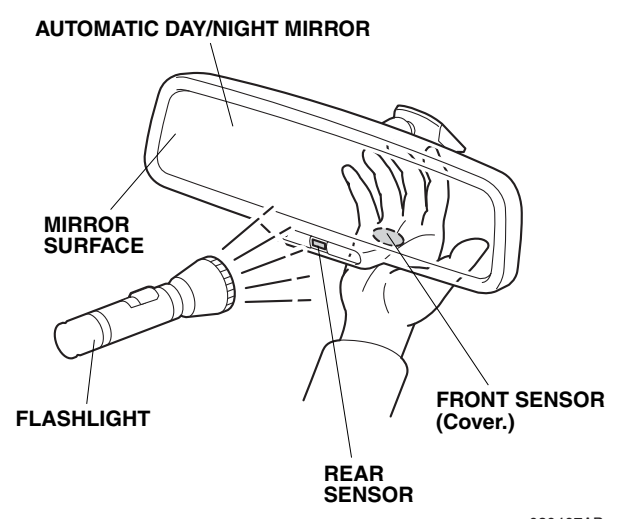

030407AB

4. Make sure the parking brake is set. Step on the brake pedal, and move the select lever to the "R" position. Repeat step 3, and make sure the mirror surface does not dim.
5. If the automatic day/night mirror does not function properly, check the fuse and all connectors, including the ground cable.