



INSTALLATION INSTRUCTIONS

Accessory

TRAILER HITCH

Application

2006 RIDGELINE

Publications No.

All 28632

Issue Date

FEB 2005

PARTS LIST

Trailer Hitch Kit:
P/N 08L92-SJC-100

Trailer hitch

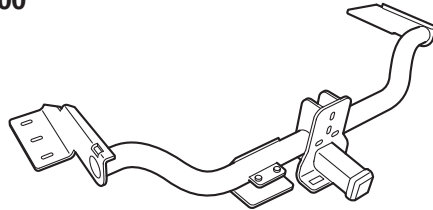

6 Bolts, 12 x 40 mm



2 Bolts, 10 x 30 mm



6 Plain washers, 12 mm



2 Plain washers, 10 mm



6 Spring washers, 12 mm



2 Spring washers, 10 mm



Hitch pin



Hitch pin clip



Receiver cover

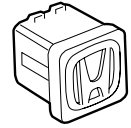

Ball mount

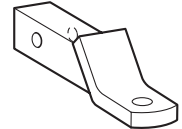

Trailer Harness Kit
P/N 08L91-SJC-100

Control unit

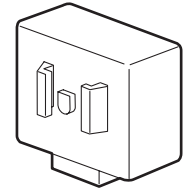

Socket

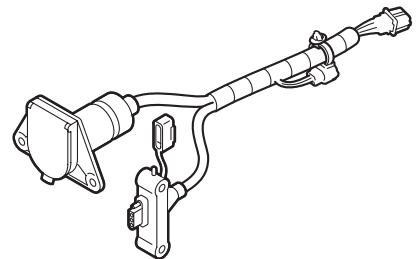

Sub fuse box upper cover

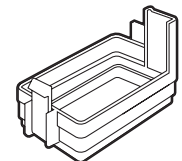

Unit bracket

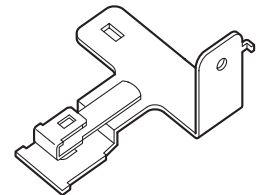

3 Fuses 20A

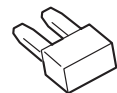

Fuse 7.5A

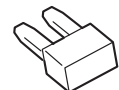

Wire tie with clip

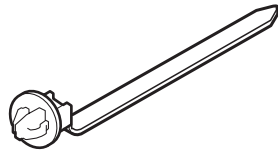

5 Flange bolts, 6 x 16 mm



Connector clip



Socket bracket

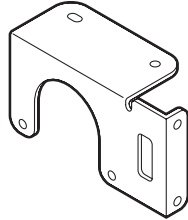

2 Flange nuts, 6 mm



2 Flange bolts, 6 x 35 mm



2 Relays

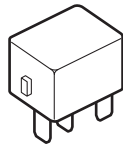

Control unit harness

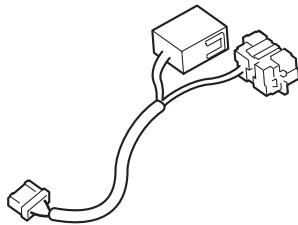

Subharness

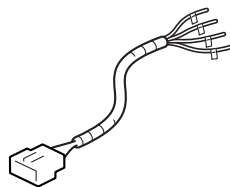

Owner's manual

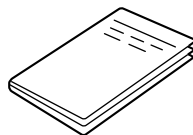

TOOLS AND SUPPLIES REQUIRED

Phillips screwdriver

Flat-tip screwdriver

Ratchet

10 mm, 14 mm, 16 mm, 17 mm and 18 mm Socket

Torque wrench

10 mm, 14 mm and 16 mm Combination wrench

Diagonal cutters

Illustration of the Trailer Hitch Installed on the Vehicle

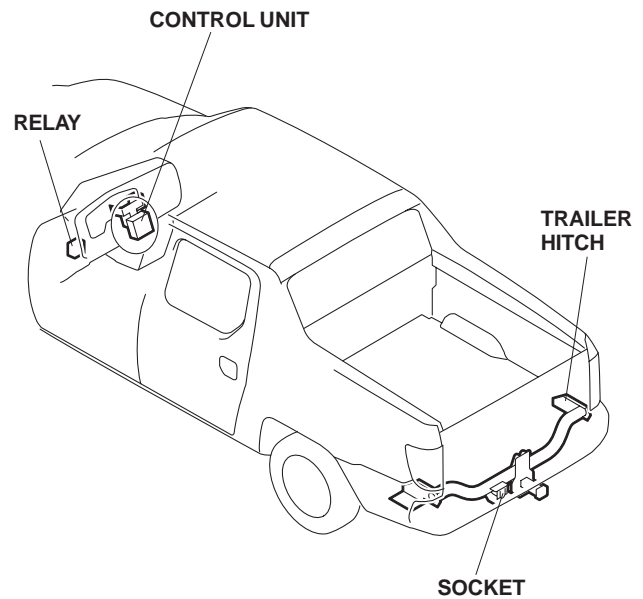

INSTALLATION

Customer Information: The information in this installation instruction is intended for use only by skilled technicians who have the proper tools, equipment, and training to correctly and safely add equipment to your vehicle. These procedures should not be attempted by "do-it-yourselfers."

1. Make sure you have the anti-theft code for the radio, then write down the radio station presets.
2. Disconnect the negative cable from the battery.

Installing the Control unit

3. Remove the left dashboard side cover (seven clips).

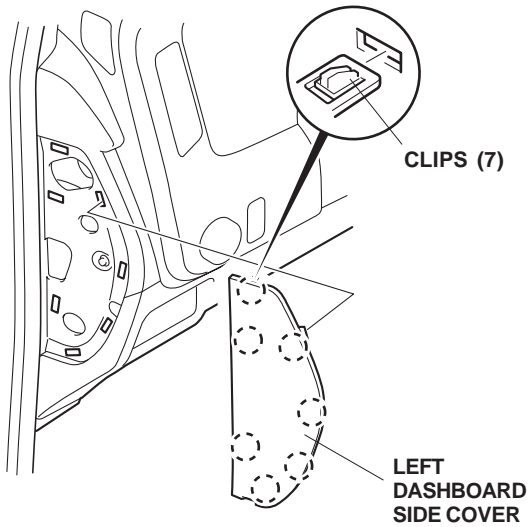

4. Remove the driver's dashboard lower cover:
 - Remove the one self-tapping screw.
 - Release the nine clips, and pull out the driver's dashboard lower cover.
 - Unplug the vehicle connectors, and remove the vehicle tube. Remove the lower cover.

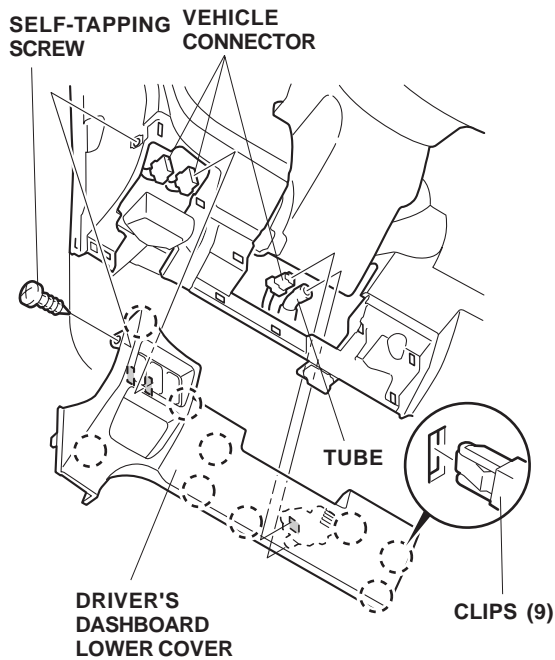

5. Install the control unit into the unit bracket. Do not push against the connector area.

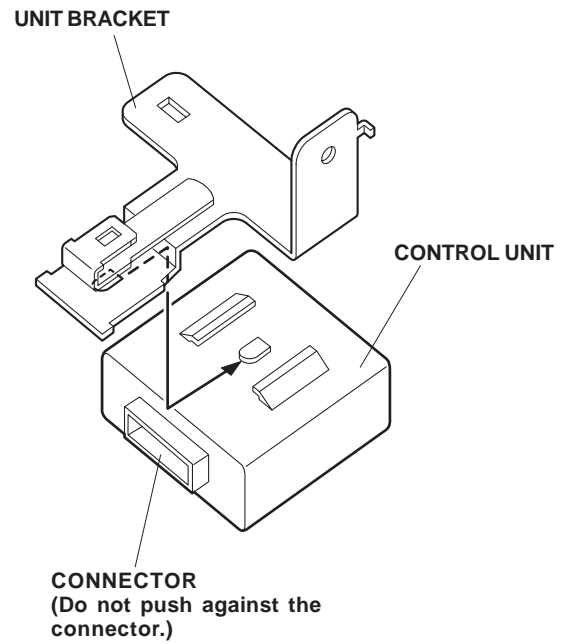

6. Get the control unit harness and one relay. Install the relay into the control unit harness relay block.

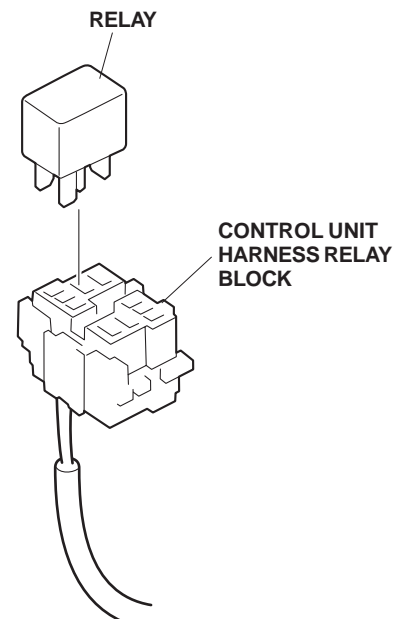

7. Plug the control unit harness 12-pin connector into the control unit.

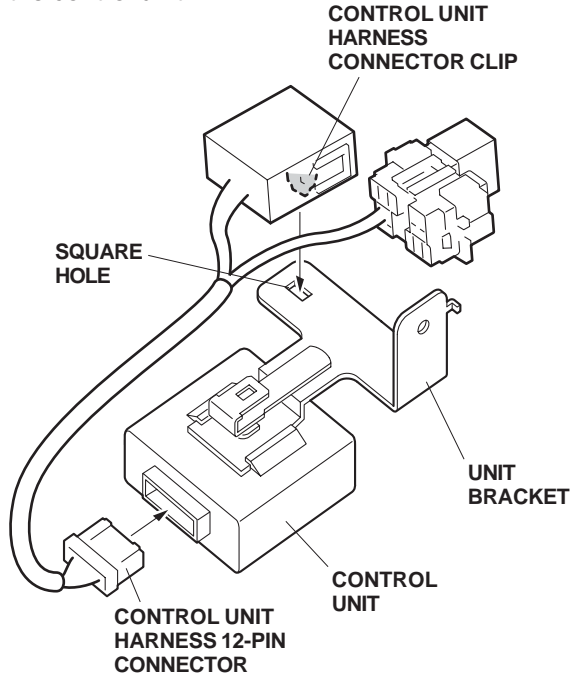

8. Push the connector clip from the control unit harness into the square hole in the unit bracket.
9. On the right side of the steering shaft, locate the vehicle 10-pin connector blue-taped to the vehicle harness, and remove the blue-tape to free the connector.

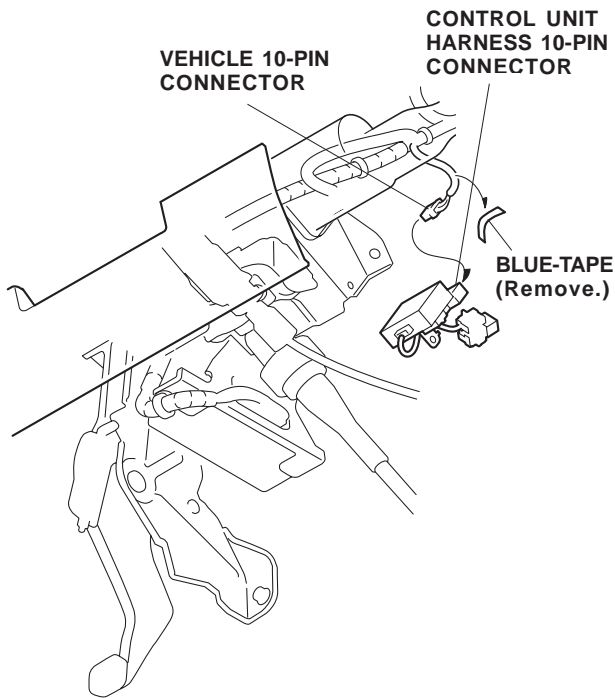

10. Plug the vehicle 10-pin connector into the control unit harness 10-pin connector.

11. Under the dashboard on the driver's side of the vehicle, install the unit bracket to the vehicle frame with one 6 x 16 mm flange bolt.

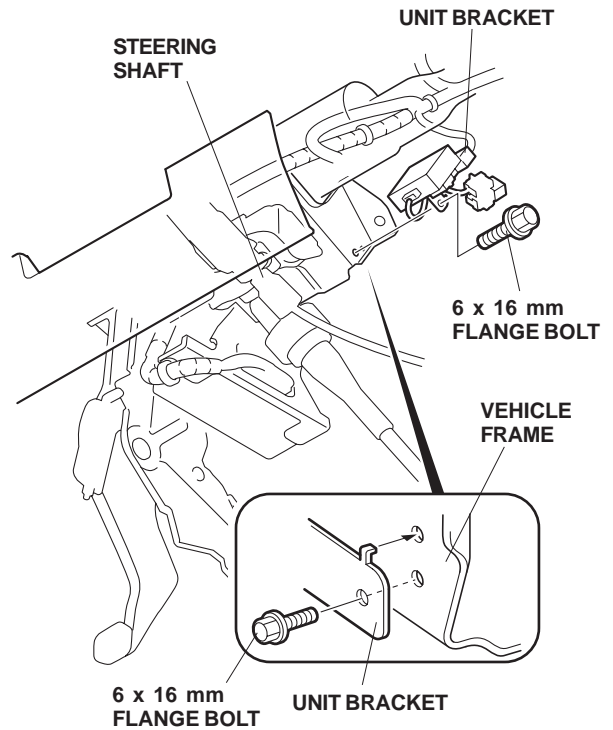

12. Install the relay block from the control unit harness to the unit bracket.

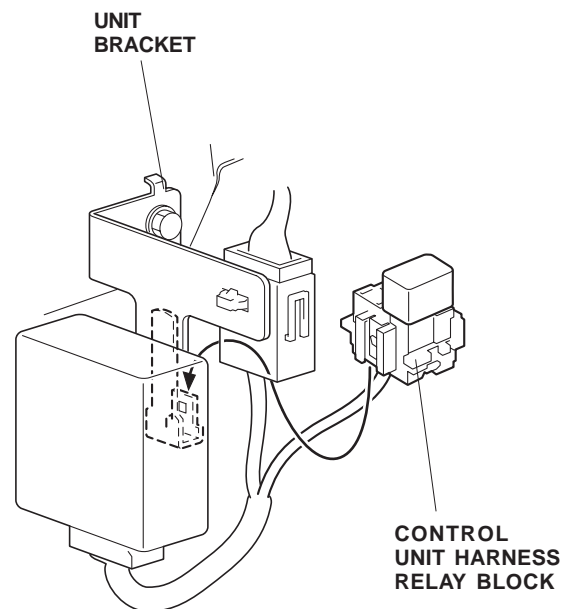

Attaching the Relay

- Using a flat-tip screwdriver through the hole in the side of the dashboard, remove the vehicle relay block as shown.

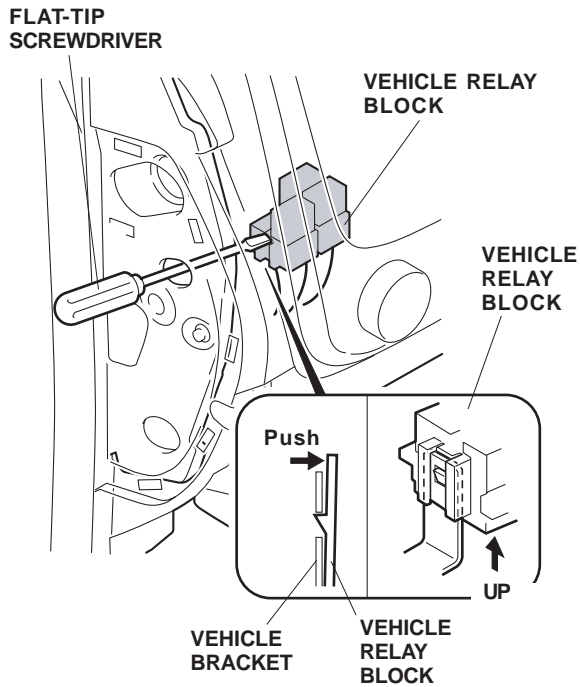

- Install the relay into the vehicle relay block, and reinstall the vehicle relay block

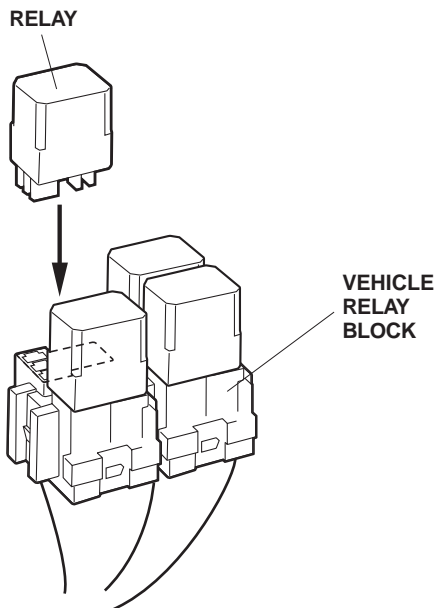

Securing the Vehicle 10-Pin Connector

- Under the rear bumper on the left side, locate the vehicle 10-pin connector green-taped to the vehicle harness. Remove the green-tape to free the connector.

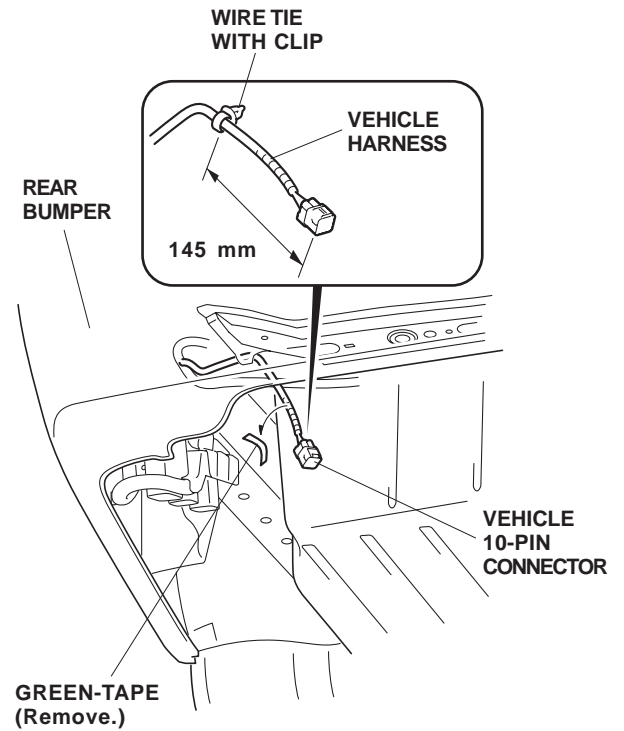

- Measure the end of the harness and attach one wire tie with clip to the vehicle harness as shown.

- Push the wire tie with clip into the hole in the vehicle frame.

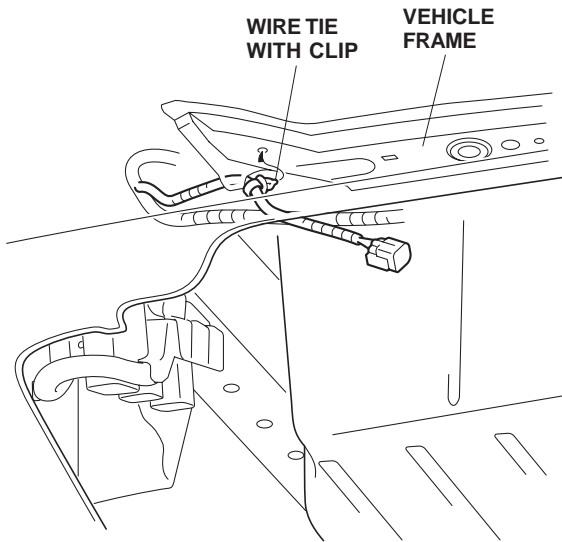

Installing the Trailer Hitch

NOTE: Allow the exhaust pipe to cool down before you remove the exhaust cover.

- Lower the muffler by removing the two rubber exhaust hangers.

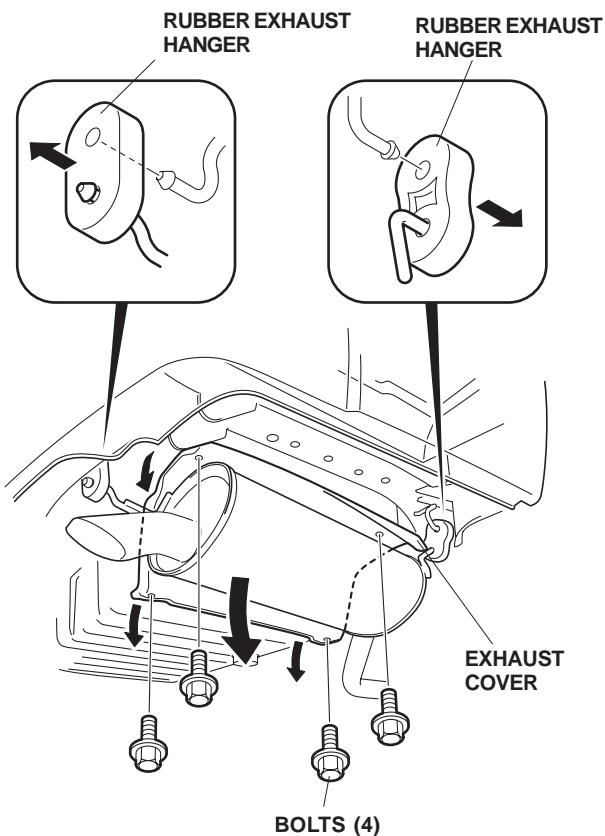

- Remove the four bolts, and slide the exhaust cover around the muffler to allow access to the trailer hitch mounting holes.

- With the help of an assistant, position the trailer hitch under the vehicle, and install six 12 x 40 mm bolts with six 12 mm plain washers and six 12 mm lock washers.

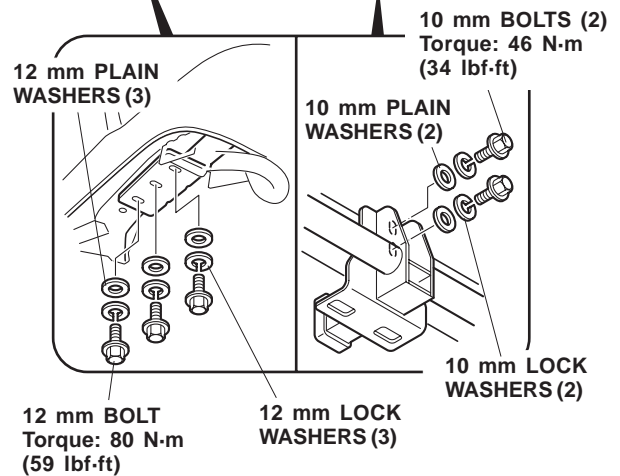
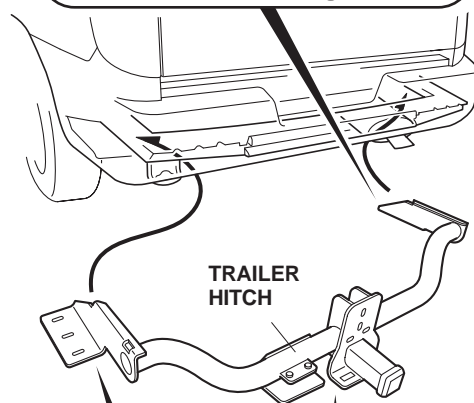
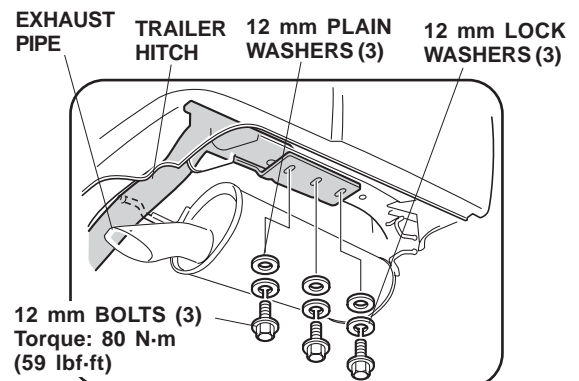

- Install two 10 x 36 mm bolts with two 10 mm plain washers and two 10 mm lock washers to secure the center of the trailer hitch. First torque the 12 x 40 mm bolts to 80 N·m (59 lbf·ft), then torque the 10 x 36 mm bolts to 46 N·m (34 lbf·ft)

- Slide the ball mount into the trailer hitch. Align the holes in the trailer hitch with the holes in the ball mount, then insert the hitch pin into the hole. Secure the hitch pin with the hitch pin clip.

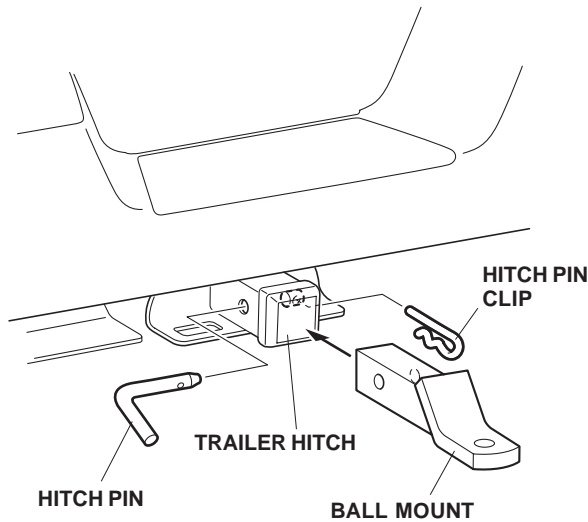

Installing the Socket

- Install the 10-pin socket to the socket bracket with two 6 x 16 mm flange bolts.

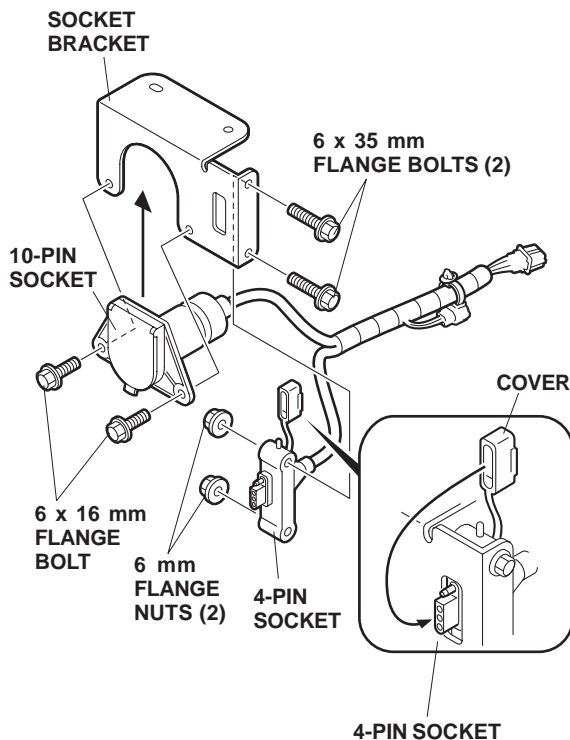

- Remove the cover from the 4-pin socket, and install the 4-pin socket to the socket bracket with two 6 x 35 mm flange bolts and two 6 mm flange nuts. Reattach the cover.

- Route the harness from the socket through the opening in the trailer hitch, and install the socket bracket to the trailer hitch with two 6 x 16 mm flange bolts.

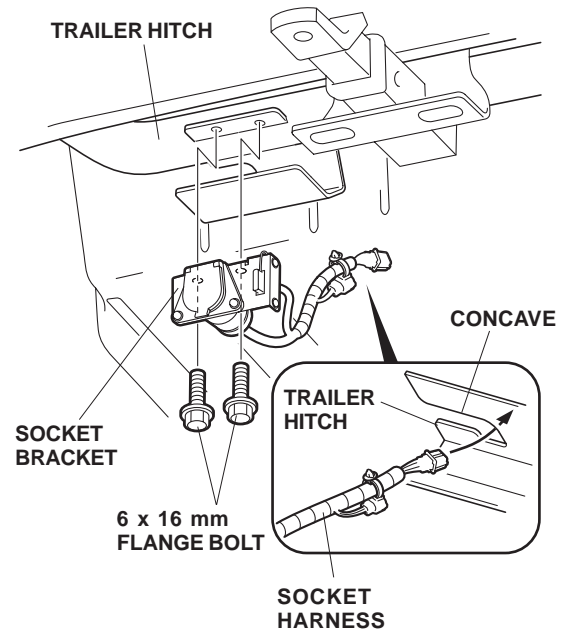

- Remove the dummy connector from the vehicle 10-pin connector, and plug the socket 10-pin connector into the vehicle 10-pin connector.

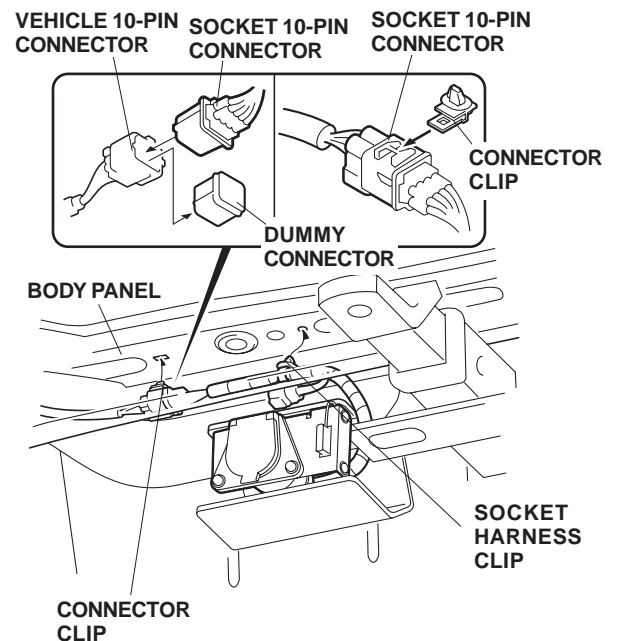

- Install the connector clip into the vehicle 10-pin connector, then push the connector clip and the socket harness clip into the holes in the body panel.

Installing the Fuses

28. Under the hood, remove the sub fuse box upper cover. Install the three 20A fuses and one 7.5 A fuse into the slots in the sub fuse box. Install the sub fuse box upper cover from the kit.

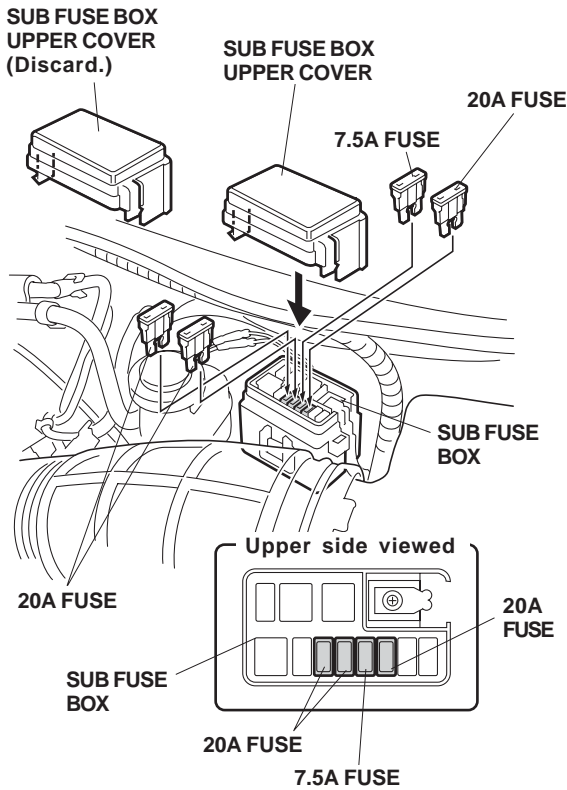

29. Check that all wire harnesses are routed properly and all connectors are plugged in.
30. Reinstall all removed parts. Check that all clips and fasteners are installed securely.
31. Reconnect the negative cable to the battery.
32. Reset the clock, and reset the radio station presets.
33. Check the operation of the trailer harness according to the Owner's Manual supplied.

NOTE: Whenever the battery is disconnected, the driver's window AUTO function is disabled.

34. Start the engine. Push down on the driver's window switch until the window is fully open.
35. Pull up on the driver's window switch fully to close the window completely, then hold the switch for 2 seconds or more.
36. Test the window AUTO function.

NOTE: After about 620 miles (1,000 km) of use, retighten the bolts and nuts to the specified torque.

Installing the Subharness

This subharness is used with an electric brake controller (sold separately). Refer to the vehicle Owner's Manual for detailed information about using the subharness.

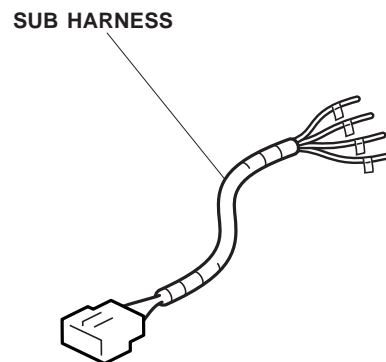

CIRCUIT DIAGRAM

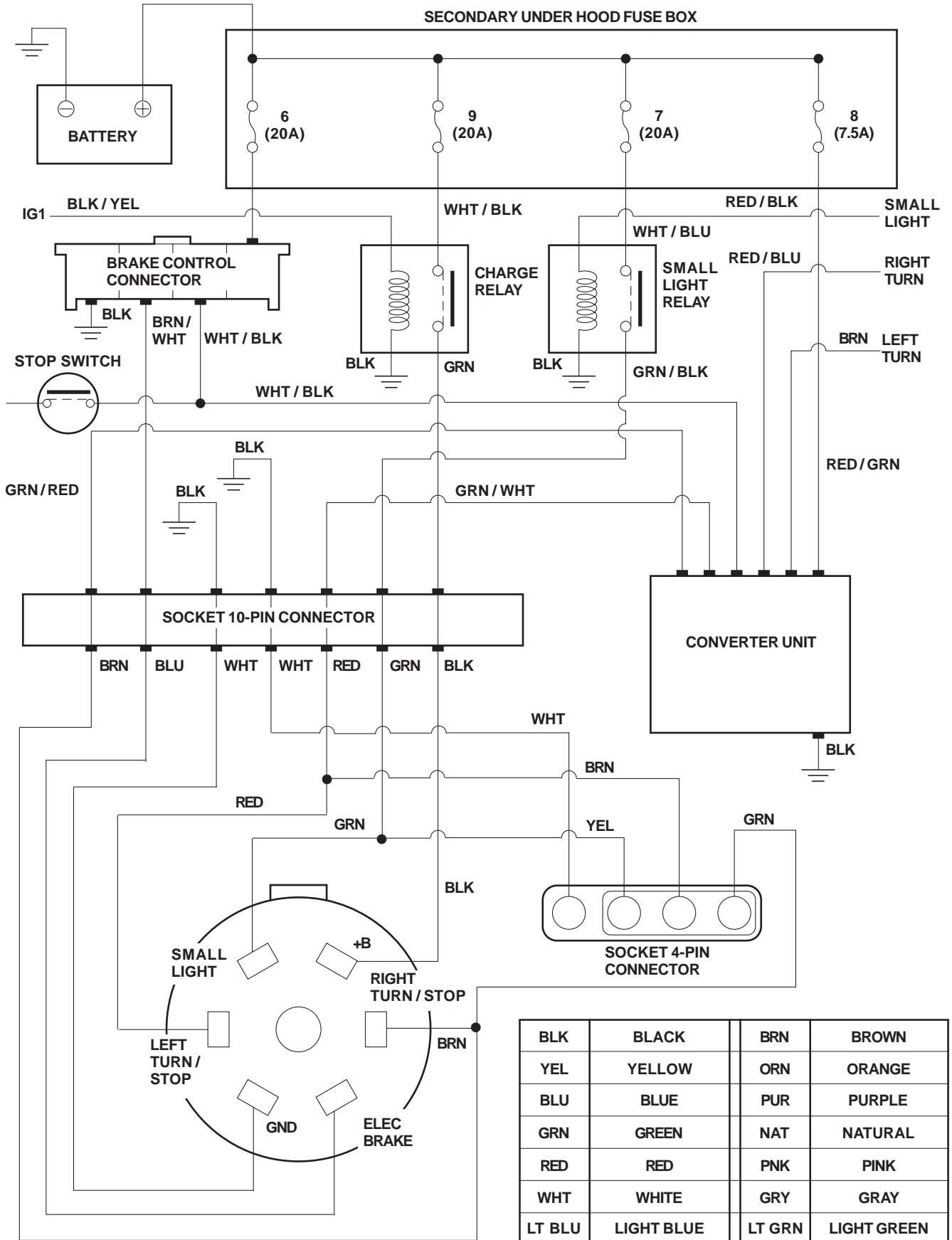

BLK	BLACK	BRN	BROWN
YEL	YELLOW	ORN	ORANGE
BLU	BLUE	PUR	PURPLE
GRN	GREEN	NAT	NATURAL
RED	RED	PNK	PINK
WHT	WHITE	GRY	GRAY
LT BLU	LIGHT BLUE	LT GRN	LIGHT GREEN